

## HIGHLIGHTS

Quartz Countertops throughout

9' Main Floors

36" Upper Cabinets

Full Tile Backsplash

Walk In Pantry

Electric HWT

Luxury Vinyl Standard on Main Floor & Wet Areas

Master Ensuite & Walk In Closet

Upper Floor Laundry

## STERLING EVOLVE

Best Warranty in the City

Award Winning Design Center Design Q

65+ Years of Building Experience

## EVOLVE Apex

Front Attached Home | 2,000 Sq. Ft.  
3 Bed | 2.5 Bath

Main Floor | 893 Sq. Ft.

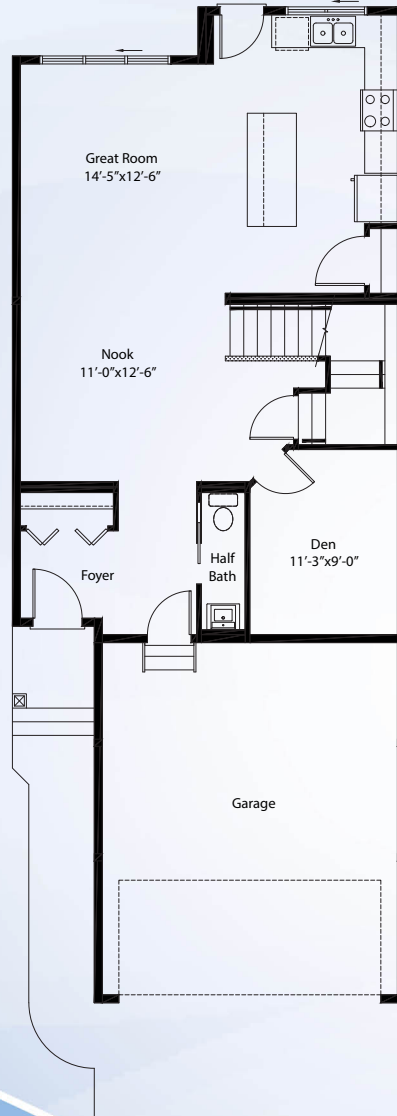

Upper Floor | 1107 Sq. Ft.

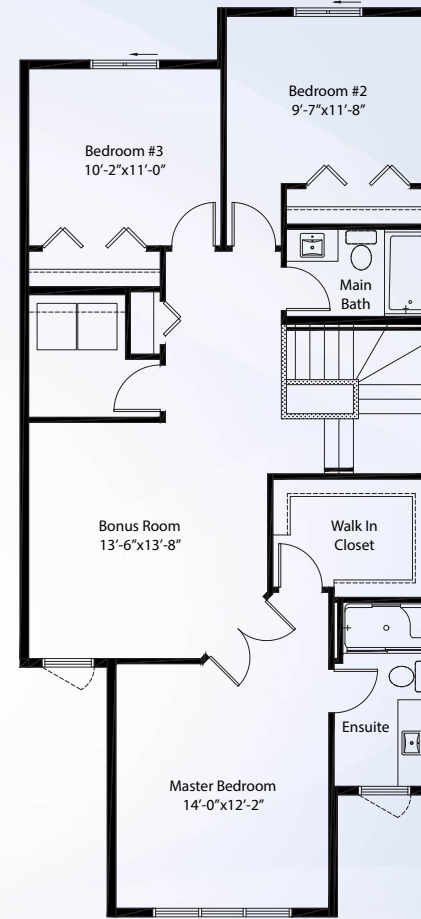

# Sterling HOMES

A QUALICO Company

## ELEVATIONS



[sterlingedmonton.com](http://sterlingedmonton.com)

Basement

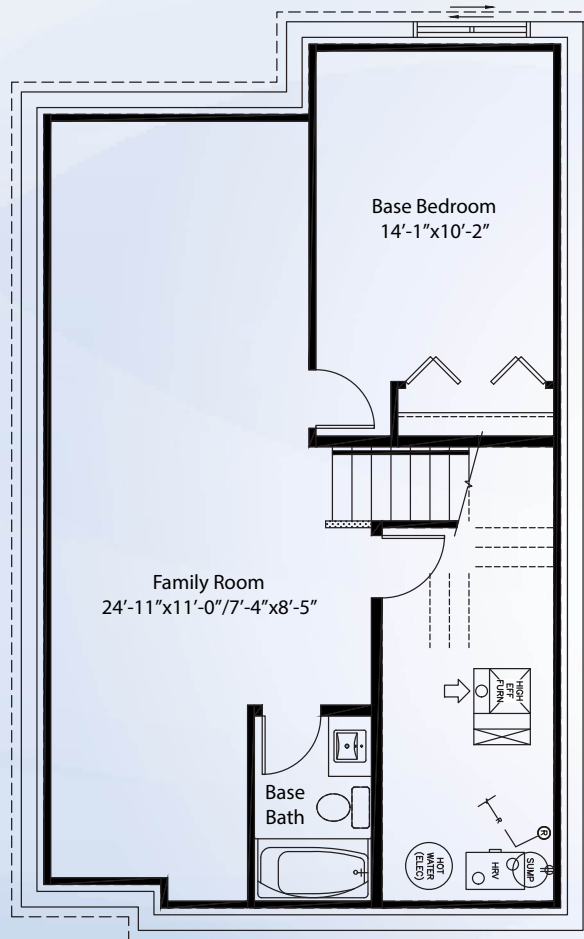

Optional Basement Legal Suite

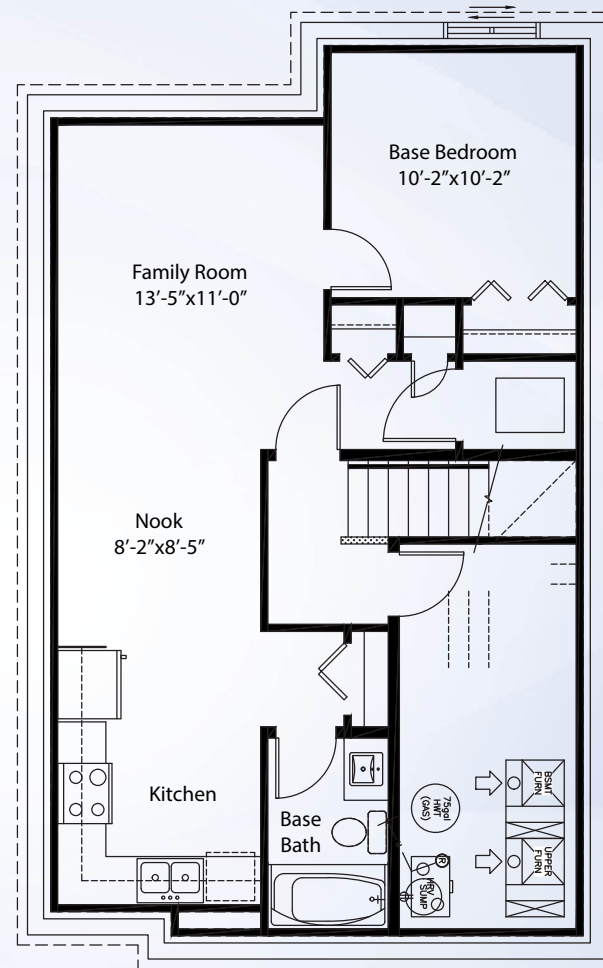

**Optional Ensuite**

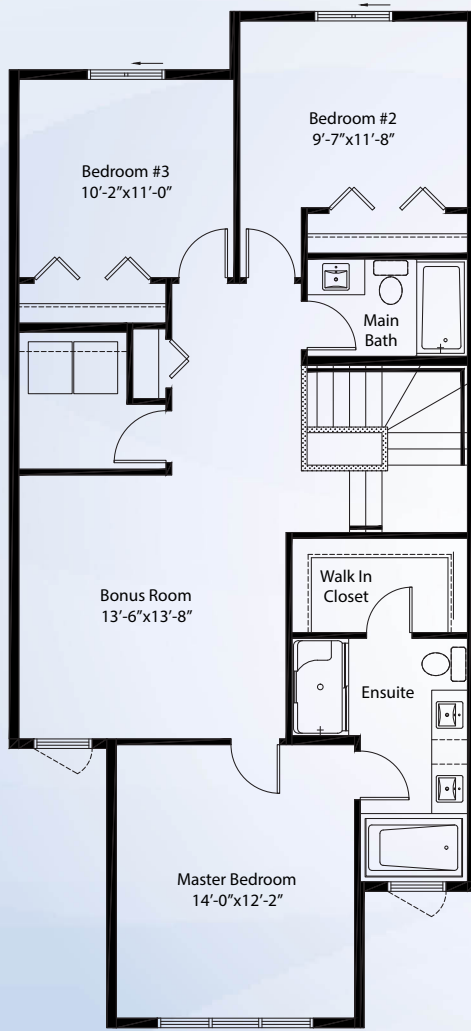

**Optional Mudroom**

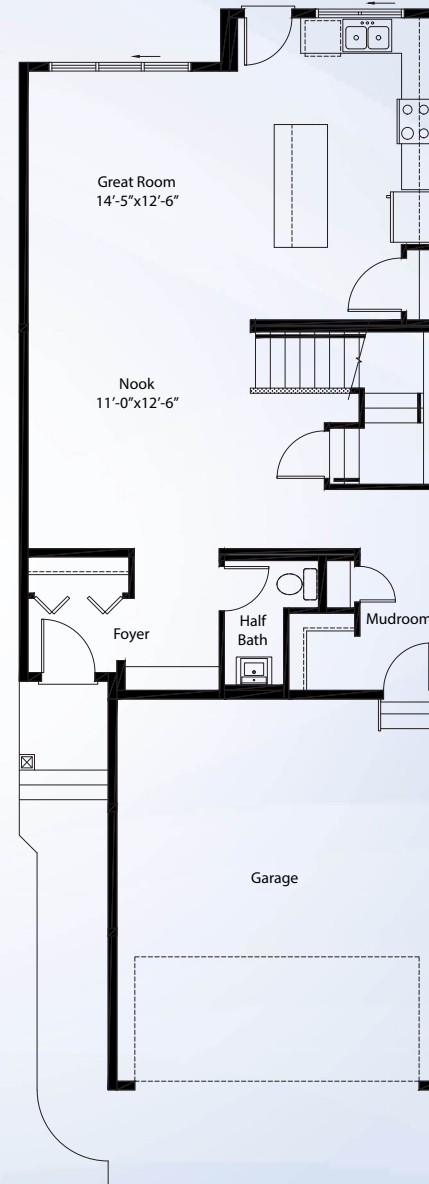

Optional Main Floor Bedroom

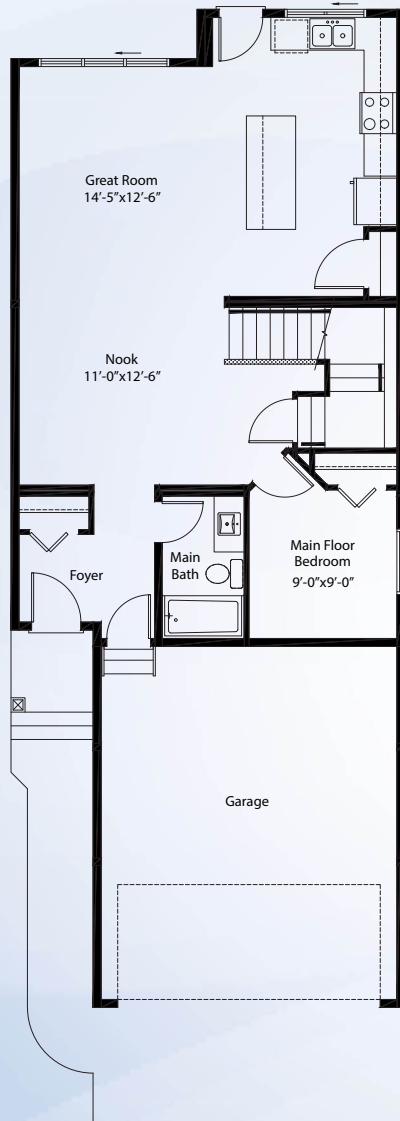

Optional Kitchen Layout

